

DOCK

DOCK 5

Workspace for High Tech
and Innovative Business



DOCK 5 consist of 9 light industrial units and with mezzanine floor.
The size in sqft shown in the plan includes the mezzanine area.

- Brand new high-quality net carbon zero Grade A office in Space City
- Reception during office hours
- Visitor, cycle, and on-site parking
- Meeting rooms and showers facility
- Communal kitchen and bin yard
- Alarmed units with out of hours security
- Electric vehicle charging points
- 2-years lease with break clause at any time with 3-months' notice.
- Opportunity to network and collaborate

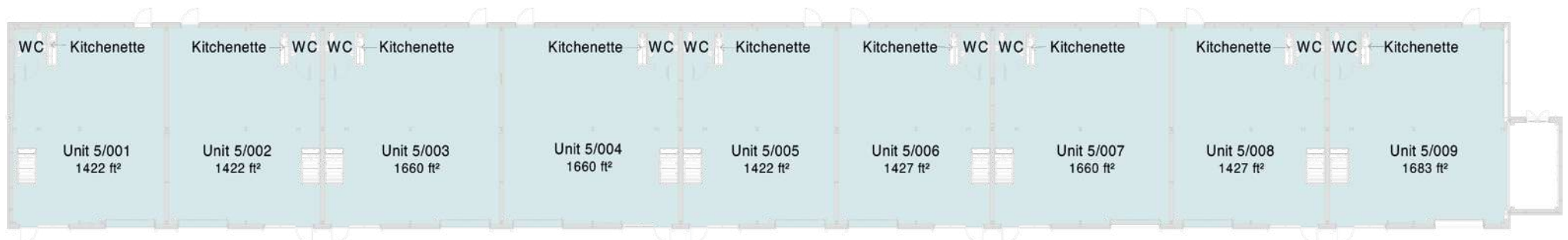

DOCK 5 GROUND FLOOR

For more information:

+44 (0)116 507 5155

DOCK-3@leicester.gov.uk

www.dockleicester.co.uk



Funded by
UK Government

POWERED BY
**LEVELLING
UP**



Leicester
City Council

DOCK

DOCK 5
Workspace for High Tech
and Innovative Business

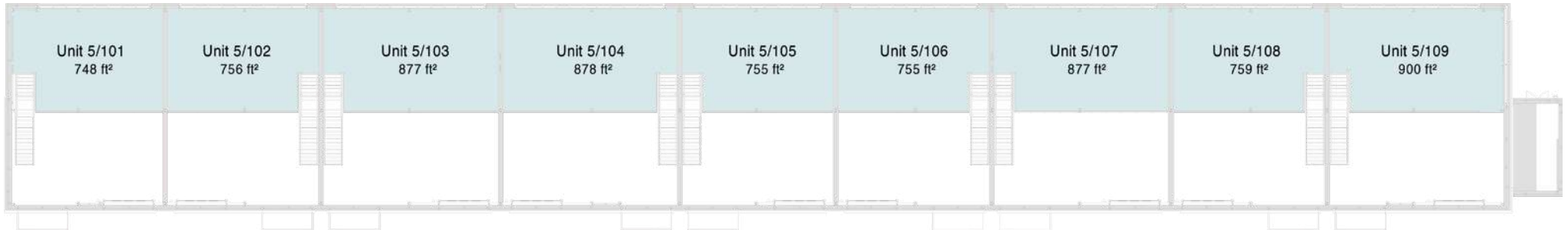

DOCK 5 MEZZANINE



For more information:

+44 (0)116 507 5155

DOCK-3@leicester.gov.uk

www.dockleicester.co.uk

 Funded by
UK Government

POWERED BY
**LEVELLING
UP**

 Leicester
City Council

DOCK

DOCK 5

Workspace for High Tech
and Innovative Business

DOCK 5 Industrial Units TO LET

Unit No.	Unit Size (Including mezzanine)	Total Rent Per Annum (Including Service Charge)
5.001	2,175 sqft	£34,148
5.002	2,185 sqft	£34,305
5.003	2,539 sqft	£39,862
5.004	2,539 sqft	£39,862
5.005	2,185 sqft	£34,305
5.006	2,185 sqft	£34,305
5.007	2,539 sqft	£39,862
5.008	2,185 sqft	£34,305
5.009	2,543 sqft	£39,925

- EPC Rating A
- Within a gated and serviced workspace community
- Flexible lease with break at any time
- Car parking and EV charging stations available
- Lessor responsible for all repairs to the building
- Price includes service charge and VAT is applicable



For more information:

Dock-3@leicester.gov.uk

+44 (0)116 507 5155

Dock 3-5, Space City, Leicester LE4 5JU

or

Crystal Carter

crystal.carter@leicester.gov.uk

www.dockleicester.co.uk

Funded by
UK Government

POWERED BY
**LEVELLING
UP**

Leicester
City Council